

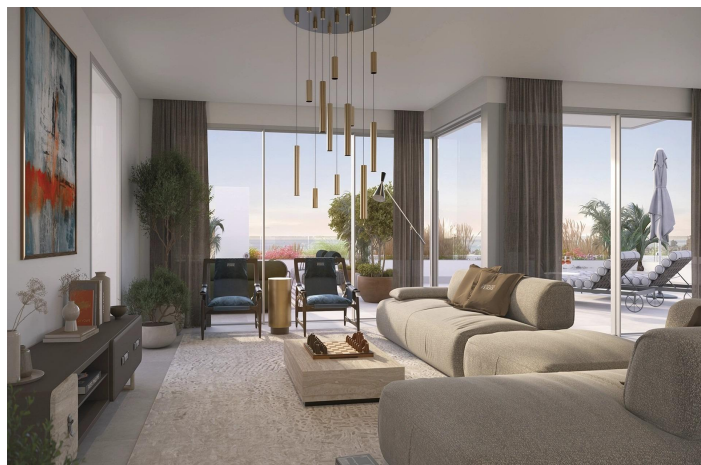

## Penthouse for sale in San Pedro de Alcántara, Marbella

**1,496,150 €**

Reference: SP1418   Bedrooms: 3   Bathrooms: 2   Build Size: 212m<sup>2</sup>   Terrace: 78m<sup>2</sup>

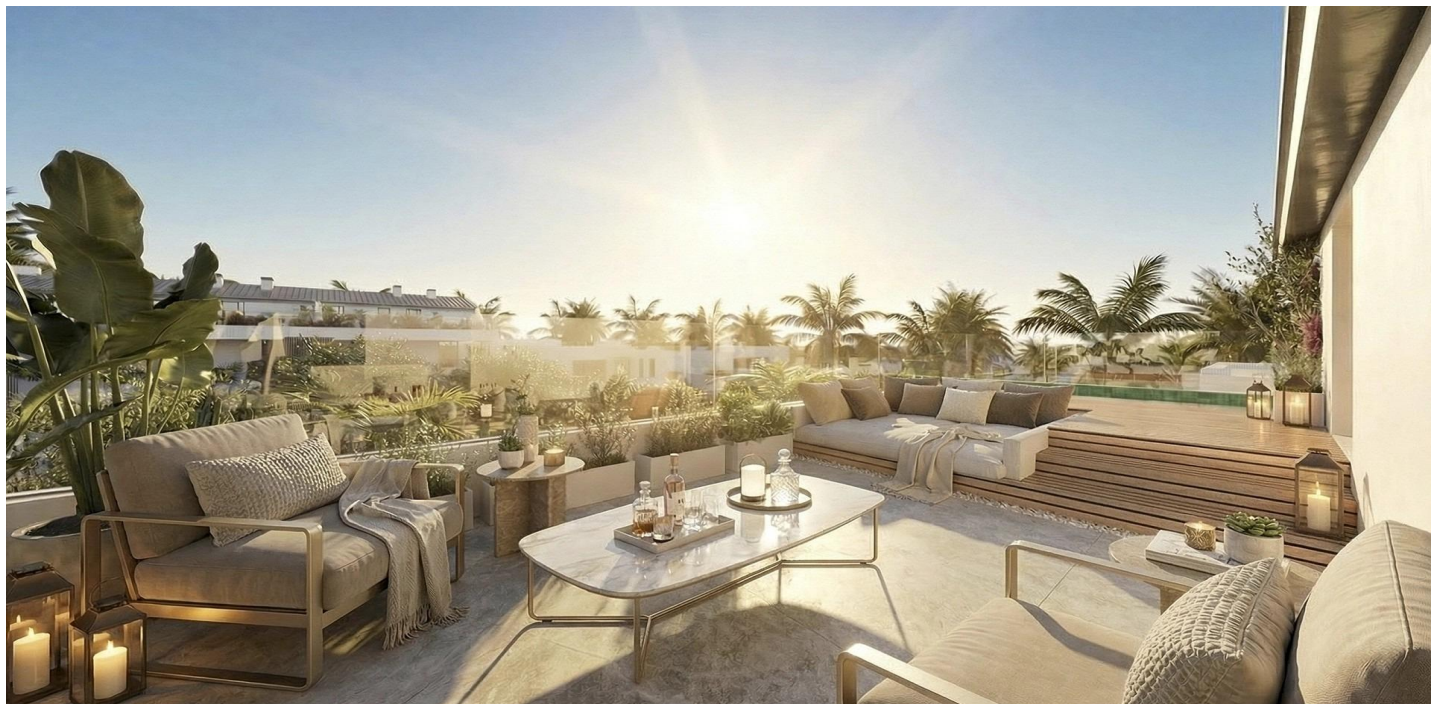





---

## Costa del Sol, San Pedro de Alcántara

**Luxury New Build Apartments in Marbella West with Resort Style Amenities Prime Location in Marbella West** This modern and functional residential complex is located in one of the most desirable areas of Marbella West, just minutes from Puerto Banus and San Pedro de Alcantara. The area is undergoing an important transformation, combining contemporary urban planning, modern infrastructure and a high quality residential environment with strong growth potential. Surrounded by prestigious neighborhoods, the location offers an ideal balance between tranquility, connectivity and an exclusive Costa del Sol lifestyle. Within a short distance you will find beach clubs, the seafront promenade, international schools, leading medical centers, sports facilities and renowned golf courses. The area is also well known for its nautical offer and proximity to key destinations along the coast.

**Contemporary Homes Designed for Comfort** The development consists of 139 new build homes with 1 to 4 bedrooms, designed to maximize natural light, comfort and a seamless connection with the surrounding environment. Spacious interiors, balanced layouts and large windows create bright and welcoming living spaces. Each home includes a private storage room and features high quality finishes that reflect modern Mediterranean elegance. The interior design uses a palette of soft natural tones inspired by sand, stone and wood, creating calm and sophisticated environments aligned with the highest standards of the Costa del Sol real estate market.

**Five Star Resort Style Amenities** This exclusive residential complex offers outstanding amenities comparable to a luxury hotel. Residents can enjoy a large outdoor swimming pool, a heated indoor pool, a fully equipped gym, spa facilities, a social lounge and landscaped gardens. One of the highlights is the rooftop lounge with a yoga area and an impressive sky pool, offering an elevated lifestyle experience throughout the year. The complex also includes safe and carefully designed spaces for both adults and children, ensuring comfort, security and privacy for all residents.

**High Quality Specifications and Technology** Homes are equipped with motorized shutters in bedrooms, fully installed ducted air conditioning, aerothermal systems for energy efficiency, armored entrance doors and bathrooms with furniture, mirrors and shower screens. Kitchens are fully equipped with high end appliances, combining functionality and contemporary design.

**Distances to Key Points of Interest** Beach is 1200m away while Puerto Banus Marina is approximately 3 km away. San Pedro de Alcantara town center is around 1 km. Several top golf courses such as Guadalmina Golf and Atalaya Golf are within 3 to 5 km. Malaga International Airport is located approximately 60 km away, offering excellent connections across Europe.

**Your New Lifestyle on the Costa del Sol** This is a unique opportunity to own a new build home in a high growth area of Marbella West, combining luxury, comfort and long term value. Contact us today to receive more information or to arrange a private viewing of this exceptional residential project.



## Features:

| Features                         | Energy Rating | CO2 Emission Rating |
|----------------------------------|---------------|---------------------|
| Gym                              | A             | A                   |
| Number of Parking Spaces: 1      |               |                     |
| Communal Pool                    |               |                     |
| Near Schools                     |               |                     |
| Useable Build Space: 139 Msq.    |               |                     |
| Beach: 1200 Meters               |               |                     |
| Solarium: Yes                    |               |                     |
| Near Childrens Parks             |               |                     |
| Location: Coastal, Urbanisation  |               |                     |
| Private Pool                     |               |                     |
| Double Bedrooms: 3               |               |                     |
| Gated                            |               |                     |
| Under-Build / Basement           |               |                     |
| Near Commercial Center           |               |                     |
| Elevator/Lift                    |               |                     |
| Terrace: 78 Msq.                 |               |                     |
| Near Trees                       |               |                     |
| Near Golf / Golf Resort Property |               |                     |
| First Line to the Sea            |               |                     |
| Near Bus Route                   |               |                     |